

Ex Roof Plan

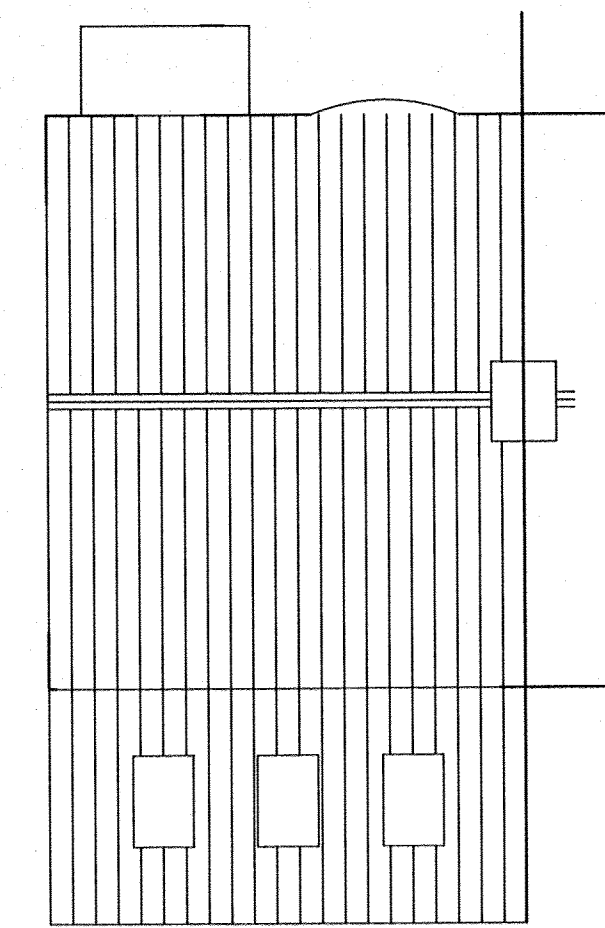

Prop Roof Plan

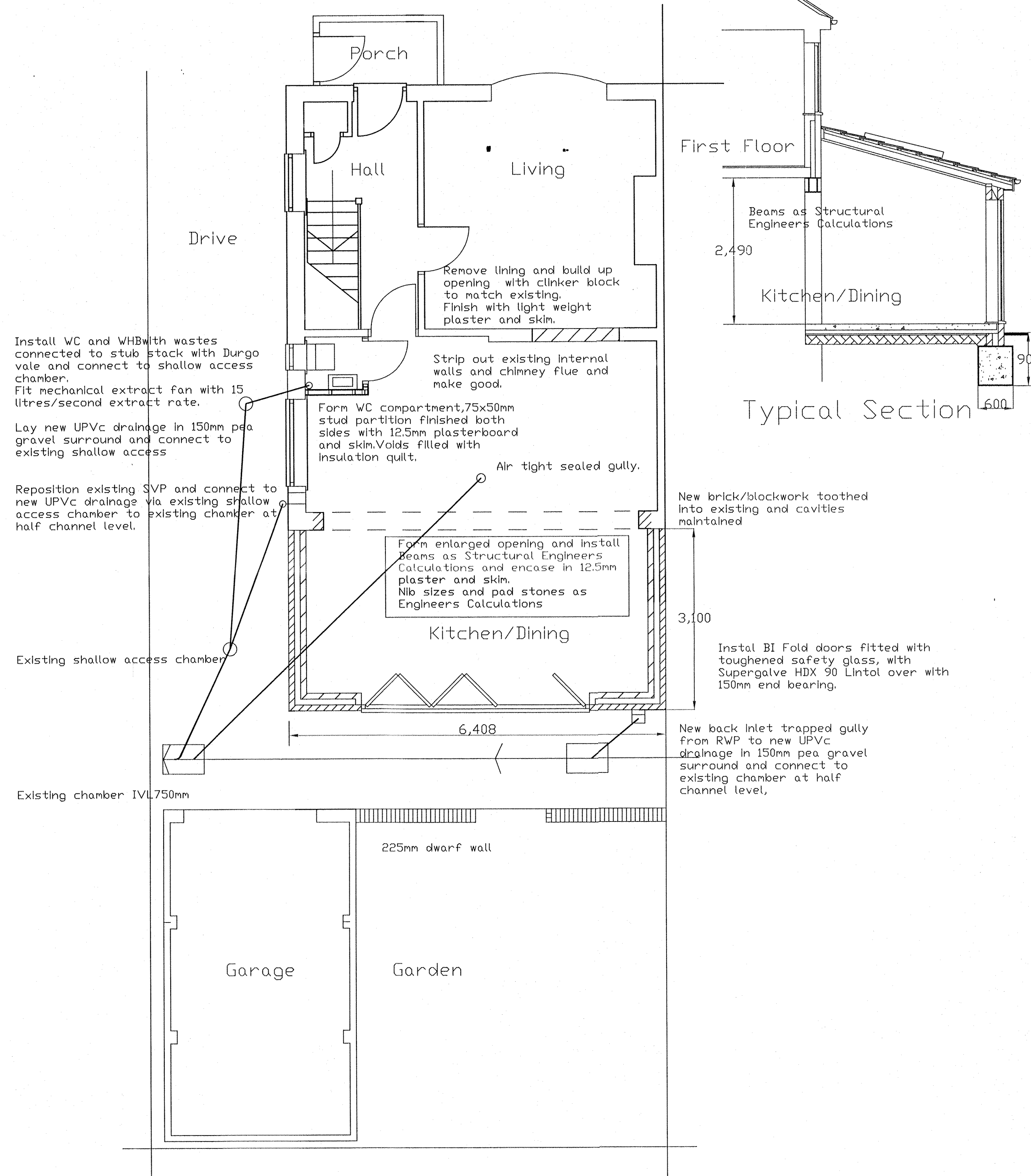
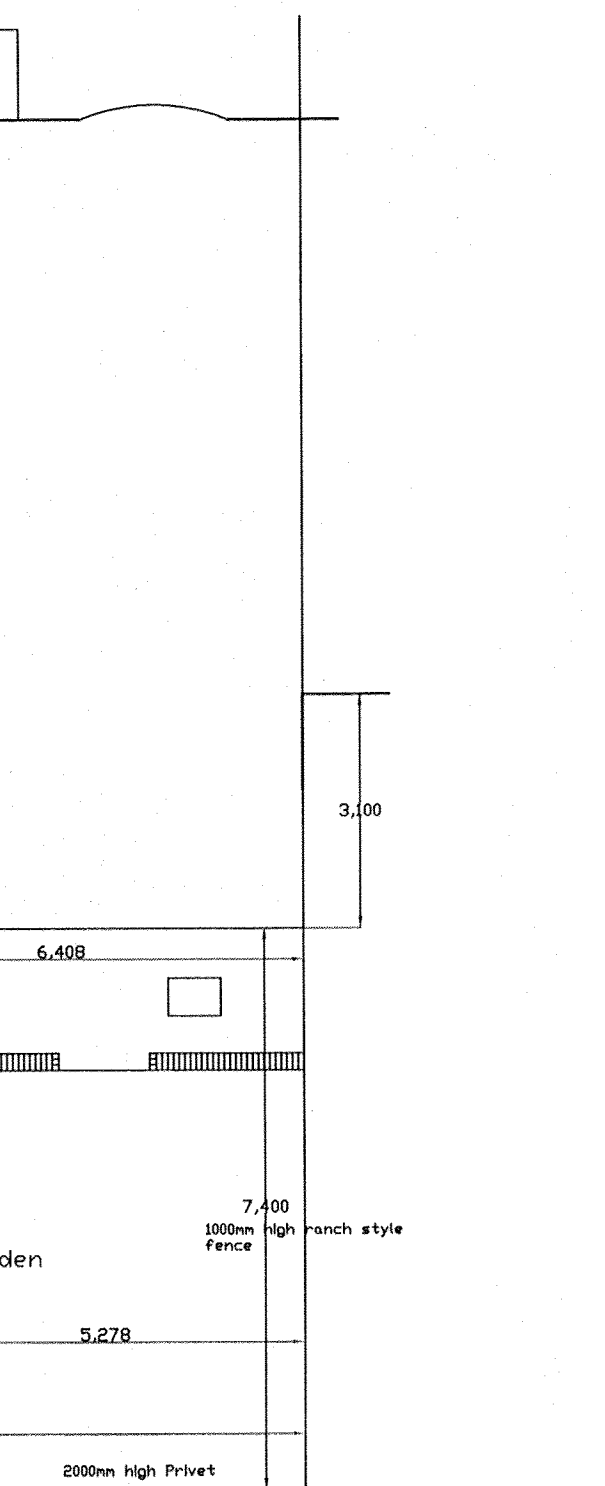

New Roof; Tiles to match existing for colour and texture fixed on 25x50mm battens in accordance with Manufacturers instructions and have a minimum 100mm head lap on 1Breathable sarking felt (Tyvec Supro) or similar on 150x50mm C24 stress grade rafters @400mm centres, doubled up around Velux Roof Windows with 100mm Celotex insulation boards between rafters and 35mm over face finished with 12.5mm plaster board and skim.  
150mm code 4 lead upstand flashing wedged into brickwork joints with stepped cavity tray over with weep holes at 880mm centres.

100x50 and 175x50mm wallplates rawl bolted to inner leaf blockwork and main house wall.  
900x30x5mm galvanized straps screw fixed to inner leaf blockwork and wallplate

110mm deep flow PVC eaves gutter with brackets @ 600mm external to 25mm external quality ply facia and 12.5 mm external quality ply soffit wit 68mm diameter PVC RWP.

Insert Supergalv HD90 lintel over new brickwork opening with 150mm end bearing

New Walling; 100mm facing brick to match toothed into existing 100 mm cavity fully filled with Rockwool Cavity Bats 100mm Thermalite Turbo blocks finished with 15mm light weight plaster and skim.

Wall Ties; Insert stainless steel wall ties to DD140 @ 750mm horizontally and 450mm vertically and 250mm centres to undressed Jamb.

Insert Patent insulated cavity closer's to all vertical and horizontal Jamb.

Insert horizontal DPCs to both internal and external leaf's minimum 150mm above ground level.

New Floor; 100mm concrete slab on 75mm Celotextuff-RTM Zero GA 3075Z insulation boards on 1200 gauge visqueen DPM mechanically bonded to inner leaf DPC 25mm sand blinding and 150mm consolidated hardcore.

Foundations; Continuous concrete strip foundation offset on boundary line bottom reinforced with B 283 mesh. Minimum concrete thickness 225mm and all to BS 8004.

General;  
New doors to be glazed with low E toughened safety glass double glazed units and be fitted with trickle vents equal to 8000mm<sup>2</sup>.  
Install kitchen fittings and furniture of owners choice and install mechanical extract rate of 60 litres/second or 30 litres/second if above hob.  
Electrical; All electrical works are to meet the requirements of Part P (Electrical Safety) and must be designed, installed, inspected and tested by a person competent to do so. Prior to completion the Council must be satisfied that Part P has been complied with.  
This will require an appropriate BS 7671 electrical installation to be issued for the work by a person competent to do so.

Gas; Any alteration to an existing or installation of a new gas burning appliance must be carried out by Gas Safe registered installer

Smoke/Heat Detection; Install a mains linked smoke/heat detection system with battery back up to BS5839 part 6.